



Tira de LED

Marca: Lloyd's Modelo: LC-1344

Lloyd's® te ayuda a hacer tu casa inteligente. Toma el control desde una sola app y convierte tus espacios en lugares seguros, eficientes, cómodos y divertidos.



Lloyd's Smart



GUÍA RÁPIDA DE INSTALACIÓN

FAVOR DE LEER LA PRESENTE GUÍA DE INSTALACIÓN ANTES DE OPERAR SU PRODUCTO

"La operación de este equipo está sujeta a las siguientes dos condiciones: (1) es posible que este equipo o dispositivo no cause interferencia perjudicial y (2) este equipo o dispositivo debe aceptar cualquier interferencia, incluyendo la que pueda causar su operación no deseada".

Este artículo decorativo no se destina para utilizarse por personas (incluyendo niños) cuyas capacidades físicas, sensoriales o mentales sean diferentes o estén reducidas, carezcan de experiencia o conocimiento, a menos que dichas personas reciban una supervisión. Los niños deben supervisarse para asegurar que este artículo no sea empleado como juguete.

1. Características

- Dispositivo controlable remotamente desde cualquier lugar a través de la app
- Amplia gama de colores RGBIC (Chip independiente integrado)
- Encienda y apague el dispositivo desde la app o por comandos de voz
- Control remoto IR incluido
- No requiere Hub
- Multiusuario
- Iluminación: 80 lm
- 60 LEDs (SMD5050 RGB), 6 LEDs (IC)
- Medida: 8 cm x 1.8 cm x 5 m
- Tira de LED flexible de PVC (silicona)
- Tiempo de vida: 20,000 horas
- Uso para interiores y exteriores IP67 (el adaptador y el controlador no son impermeables)
- Temperatura de operación: -20 °C ~ 40 °C
- Módulo dual con conectividad Wi Fi y Bluetooth
- Sincronización de los colores de la luz al ritmo de la música mediante el micrófono integrado del dispositivo
- Ahorro de energía: cree diferentes horarios de encendido y apagado para un control óptimo de la iluminación
- Desde la app encienda y apague, regule el brillo, programe horarios y el color aun estando fuera de casa
- Compatible con asistentes virtuales de Amazon Alexa y Google
- Compatible con Siri Shortcuts mediante rutinas creadas desde la app
- Permite la creación de rutinas que desencadenan acciones en otros productos inteligentes Lloyd's

2. Contenido

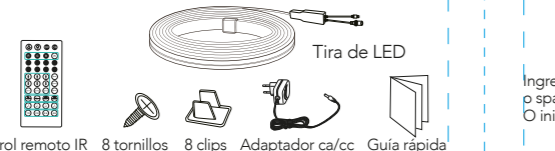

Control remoto IR 8 tornillos 8 clips Adaptador ca/cc Guía rápida

2

2

2

2

2

2

2

2

2

2

2

2

2

2

2

2

2

2

2

2

2

2

2

2

2

2

2

2

2

2

2

2

2

2

2

2

2

2

2

2

2

2

2

2

2

2

2

2

2

2

2

2

2

2

2

2

2

2

2

2

2

2

2

2

2

2

2

2

2

2

2

2

2

2

2

2

2

2

2

2

2

2

2

2

2

2

2

2

2

2

2

2

2

2

2

2

2

2

2

2

2

2

2

2

2

2

2

2

2

2

2

2

2

2

2

2

2

2

2

2

2

2

2

2

2

2

2

2

2

2

2

2

2

2

2

2

2

2

2

2

2

2

2

2

2

2

2

2

2

2

2

2

2

2

2

2

2

2

2

2

2

2

2

2

2

2

2

2

2

2

2

2

2

2

2

2

2

2

2

2

2

2

2

2

2

2

2

2

2

2

2

2

2

2

2

2

2

2

2

2

2

2

2

2

2

2

2

2

2

2

2

2

2

2

2

2

2

2

2

2

2

2

2

2

2

2

2

2

2

2

2

2

2

2

2

2

2

2

2

2

2

2

2

2

2

2

2

2

2

2

2

2

2

2

2

2

2

2

2

2

2

2

2

2

2

2

2

2

2

2

2

2

2

2

2

2

2

2

2

2

2

2

2

2

2

2

2

2

2

2

2

2

2

2

2

2

2

2

2

2

2

2

2

2

2

2

2



Smart LED strip

Brand: Lloyd's Model: LC-1344

Lloyd's® helps you make your Home a Smart Home
Take control from one single app and transform your spaces into safe, efficient, comfortable and fun places.



Lloyd's Smart



QUICK GUIDE

PLEASE READ THE INSTALLATION GUIDE BEFORE OPERATING THE PRODUCT
Operation is subject to two conditions: (1) this device may not cause harmful interference, and (2) this device must accept any interference, including interference caused by the undesired operation.

This appliance is not for persons (including children) whose physical, sensory, or mental capacities are different, reduced, lack experience or knowledge unless such persons are under supervision.
Supervise children to ensure that this device is not used as a toy.

1. Characteristics

- Device remotely controllable from anywhere through the app
- Wide range of RGBIC colors (Built-in independent chip)
- Turn the device on and off from the app or by voice commands
- IR remote control included
- No Hub required
- Multi-user
- Lighting: 80 lm
- 60 LEDs (SMD5050 RGB), 6 LEDs (IC)
- Size: .3 in x .7 in x 16.4 ft
- Flexible PVC (Silicone) LED Strip
- Lifespan: 20,000 hours
- For indoor and outdoor use IP67 (adapter and built-in controller are not waterproof)
- Operating temperature: -4 °F ~ 104 °F
- Dual module with Wi Fi and Bluetooth connectivity
- Light color syncing to the beat of the music from the app or through the device's built-in microphone
- Energy-saving: create different on/off schedules for optimal lighting control
- From the app, turn on/off, adjust brightness, schedule times, and color even when away from home
- Compatible with Amazon Alexa and Google virtual assistants
- Compatible with Siri Shortcuts through routines created from the app
- Allows you to create routines that trigger actions in other Lloyd's Smart products

2. Contents

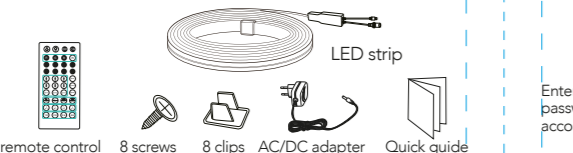

13

3. Before getting started

Make sure your smartphone has iOS 10.0 or higher or Android™ 4.4 or higher. Check your network and make sure you are connected to a 2.4 GHz Wi Fi channel.

Download the Lloyds Smart app from the App Store or on Google Play or scan the following QR code with your smartphone.



4. Registration and access

Launch the Lloyds Smart app. To register, click on "Sign Up" (1), to continue, click "Agree," choose your country and enter an email address, then click "Get Verification Code" (2).

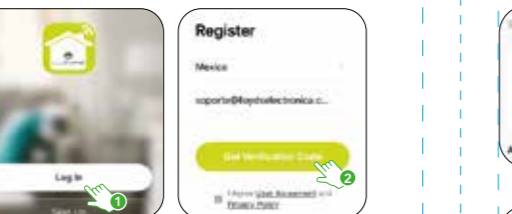

14

5. Add device

Start the Lloyds Smart app on your smartphone, select "+" (upper right corner) (1), choose the type of device that you want to add. In this case, go to "Lighting" (2), then click on "Smart Neon LED strip" (3). Enter your Wi Fi network information and password, then click "Next" (4).

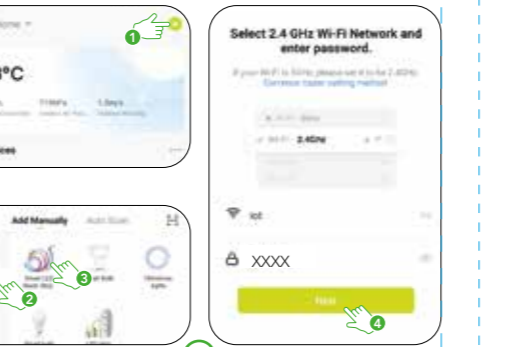

15

6. Device control

1. More functions
2. Choose from a wide range of colors
3. Raise or lower the brightness
4. Preset colors
5. RGB interface
6. Customize and select scenes
7. Sync the colors of the light with the rhythm of the music
8. On/Off scheduling
9. Choose the order in which the colors of custom scenes appear and set the LED strip to turn on either partially or whole

NOTE:
Make sure the Wi Fi password you enter is correct and that the device is close to the modem during the process.

16

7. Scene mode

1. Custom scenes
2. On/Off
3. Choose from a wide range of colors
4. Click the "+" button to save a custom scene or press on the set color to change it
5. Default scenes
6. Adjust flash firing speed
7. Raise or lower the brightness

8. Remote control

1. Raise or lower the brightness of default colors
2. Default colors
3. Increase/Decrease color brightness (applies for DIY1, DIY2, and DIY3 colors)
4. Color selection: DIY1 (red), DIY2 (green), and DIY3 (blue)
5. Modes for light color syncing to the beat of the music
6. On/Off
7. Custom scene selection
8. Adjust flash firing speed
9. Preset scenes
10. On/Off timer settings

9. How to configure with Siri Shortcuts

Lloyd's Smart products are compatible with Siri Shortcuts through routines created from the app. For configuration details, scan the following QR code with your smartphone.

17

10. Google Assistant and Amazon Alexa

NOTE:
The name that you assign to the device will be the one that you use with your Alexa or Google Assistant-enabled device for voice control.

11. Maintenance

1. Download and access the "Amazon Alexa" app, previously configured with your email account and your virtual assistant.
2. Click on the option "Skills & games", then in the search bar type Lloyds Smart. When you get the icon, click on it. Then press the "Activate to use" button.

12. Cautions

To reduce the risk of fire and electric shock:
- Disconnect the decorative product from the power supply before performing any maintenance or cleaning activities.
- Do not install or place near gas or electric heaters, fireplaces, candles or other similar sources of heat.
- Unplug the product when leaving the house, when retiring to sleep, or if left unattended.
- Do not hang decorations or other objects on the cord, cable or light strip.
- Do not cover the decorative product with cloth, paper or any material that is not part of the product when in use.
- Do not install the strip in a manner that may cut or damage the wire insulation.

18

13. Electrical specifications

LED Strip: 24 V ~ 1 A
Includes connector
Includes AC/DC Adapter:
Input: 100 – 240 V ~ 50/60 Hz 0,5 A
Output: 24 V ~ 1 A
IR remote control: 3 V ~ 1 A
(1 Battery CR2025 de 3 V ~ included)

14. Electrical specifications

NOTE:
The Google Home and Amazon Alexa apps are constantly being updated, for more information consult their assistant manuals.

15. Maintenance

- Do not expose it to direct sunlight.
- Do not immerse in water or any other liquid.
- For cleaning use a damp or dry cloth without abrasive liquids.

19

16. Cautions

NOTE:
This device is for use only with the provided power supply adapter*

17. Electrical specifications

IMPORTED BY: ZUTTO TECHNOLOGIES, S. A. DE C. V.
Avenida Ejército Nacional No. 505 Interior 1602, Col. Granada Miguel Hidalgo, Ciudad de México, México, C.P. 11520
Phone: 55 68447575
R.F.C.: ZTE161017KT6

18. Maintenance

- Do not expose it to direct sunlight.
- Do not immerse in water or any other liquid.
- For cleaning use a damp or dry cloth without abrasive liquids.

20

19. Maintenance

NOTE:
The Google Home and Amazon Alexa apps are constantly being updated, for more information consult their assistant manuals.

20. Maintenance

- Do not expose it to direct sunlight.
- Do not immerse in water or any other liquid.
- For cleaning use a damp or dry cloth without abrasive liquids.

21. Maintenance

- Do not expose it to direct sunlight.
- Do not immerse in water or any other liquid.
- For cleaning use a damp or dry cloth without abrasive liquids.

21

22. Maintenance

NOTE:
The Google Home and Amazon Alexa apps are constantly being updated, for more information consult their assistant manuals.

23. Maintenance

- Do not expose it to direct sunlight.
- Do not immerse in water or any other liquid.
- For cleaning use a damp or dry cloth without abrasive liquids.

24. Maintenance

- Do not expose it to direct sunlight.
- Do not immerse in water or any other liquid.
- For cleaning use a damp or dry cloth without abrasive liquids.

22